

## Body

Corrosion resistant non-metallic canister  
Fully potted wire cavity provides water-tight seal  
Adjustable lamp gimble for optimal results

## Debris Guard

Solid cast brass faceplate with grate

## Lamp

For use with a halogen lamp up to 20W MR16 lamp.  
LT TECH LED lamps are available in 4W,5W and 6W  
MR16,in 2700K and 3000K.

## Materials

Die-cast brass,PVC

## Gasket

High-temperature silicone o-ring for a  
water-tight seal

## Lens

Shock resistant glass lens

## Warranty

Limited lifetime warranty





**LT2203A**

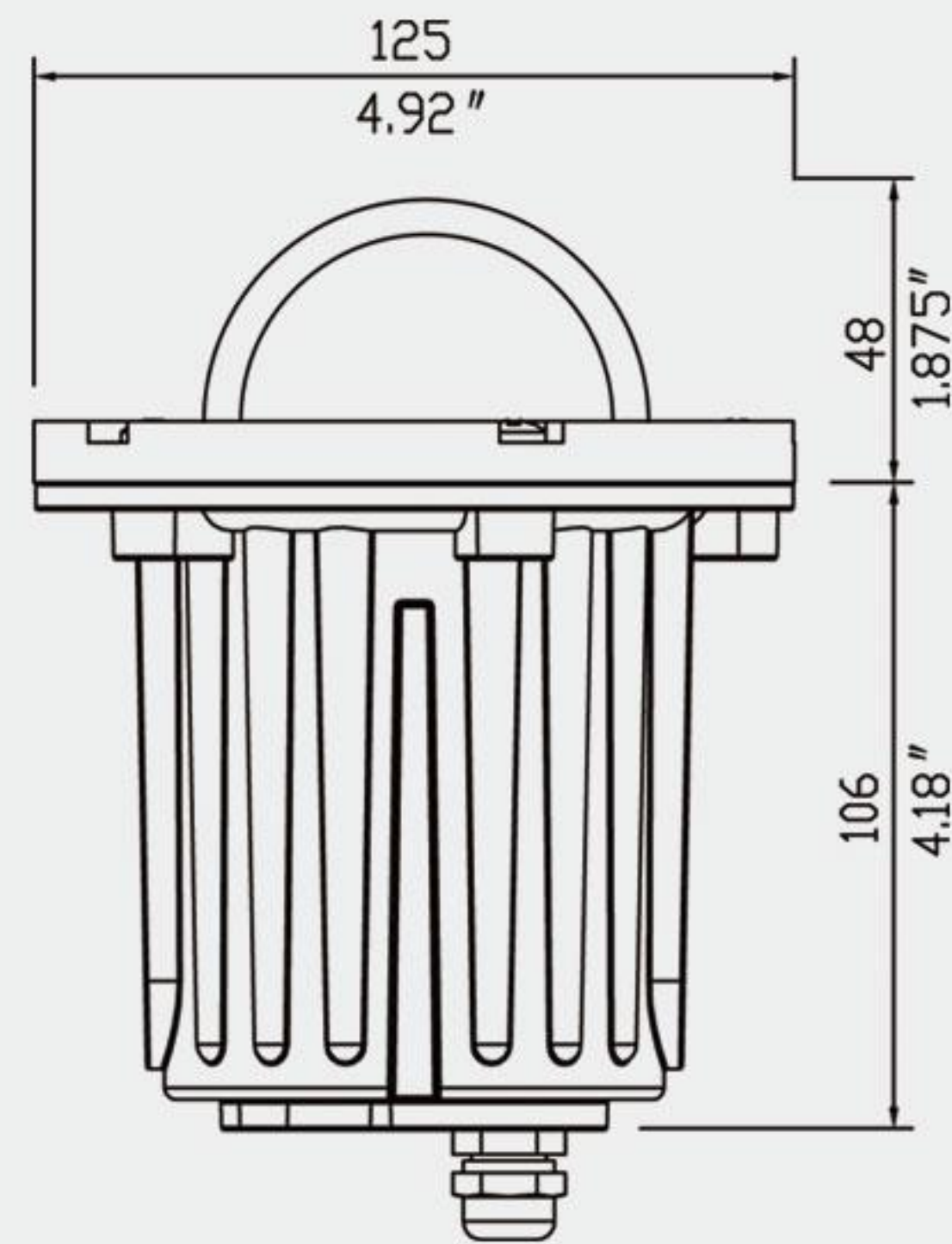

**LT2203B**

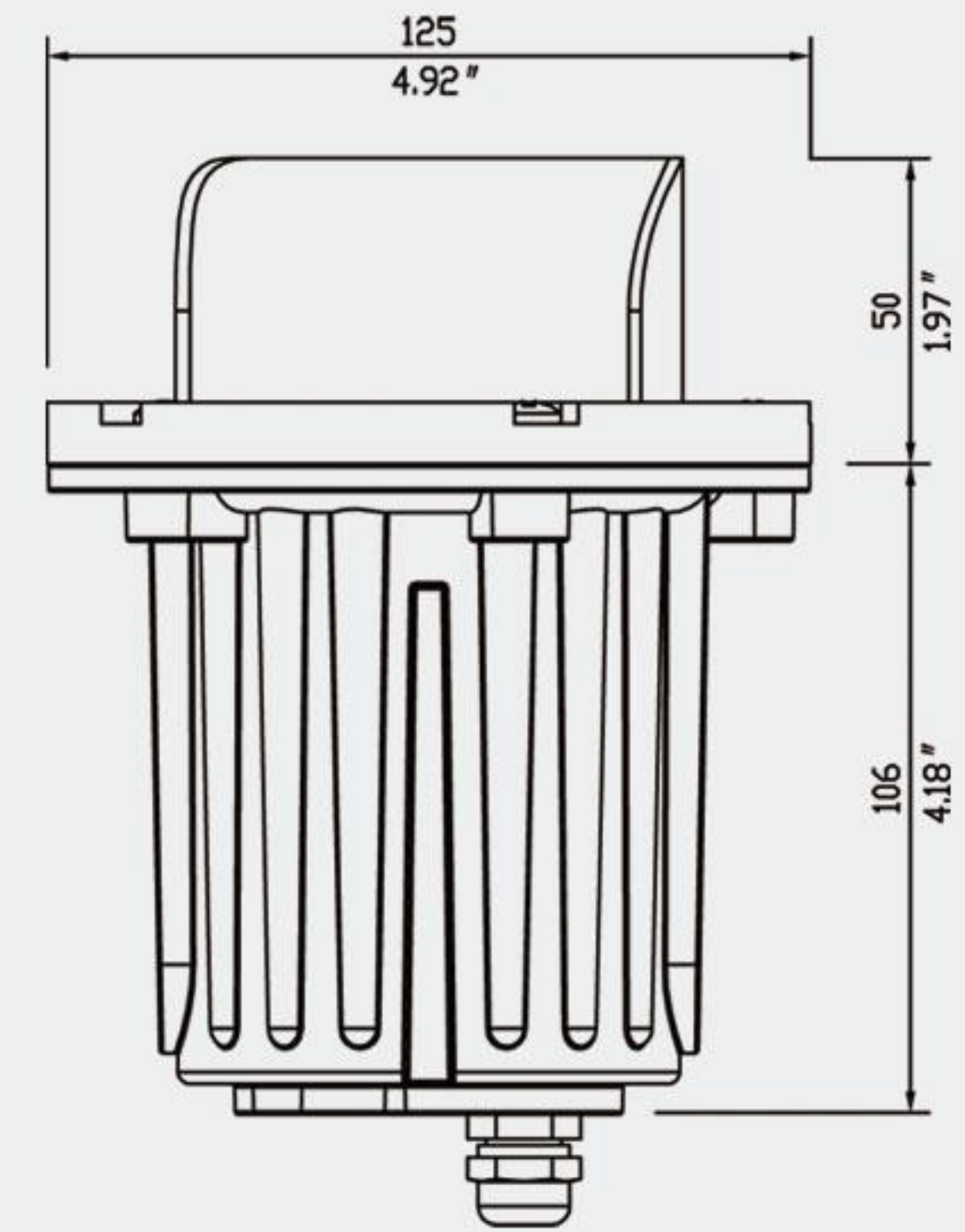

## Body

Corrosion resistant non-metallic canister  
Fully potted wire cavity provides water-tight seal  
Adjustable lamp gimble for optimal results

## Debris Guard

Solid cast brass faceplate with grate

## Lamp

For use with a halogen lamp up to 20W MR16 lamp.  
LT TECH LED lamps are available in 4W,5W and 6W  
MR16,in 2700K and 3000K.

## Materials

Die-cast brass,PVC

## Gasket

High-temperature silicone o-ring for a  
water-tight seal

## Lens

Shock resistant glass lens

## Warranty

Limited lifetime warranty





LT2204A



LT2204B



LT2204C

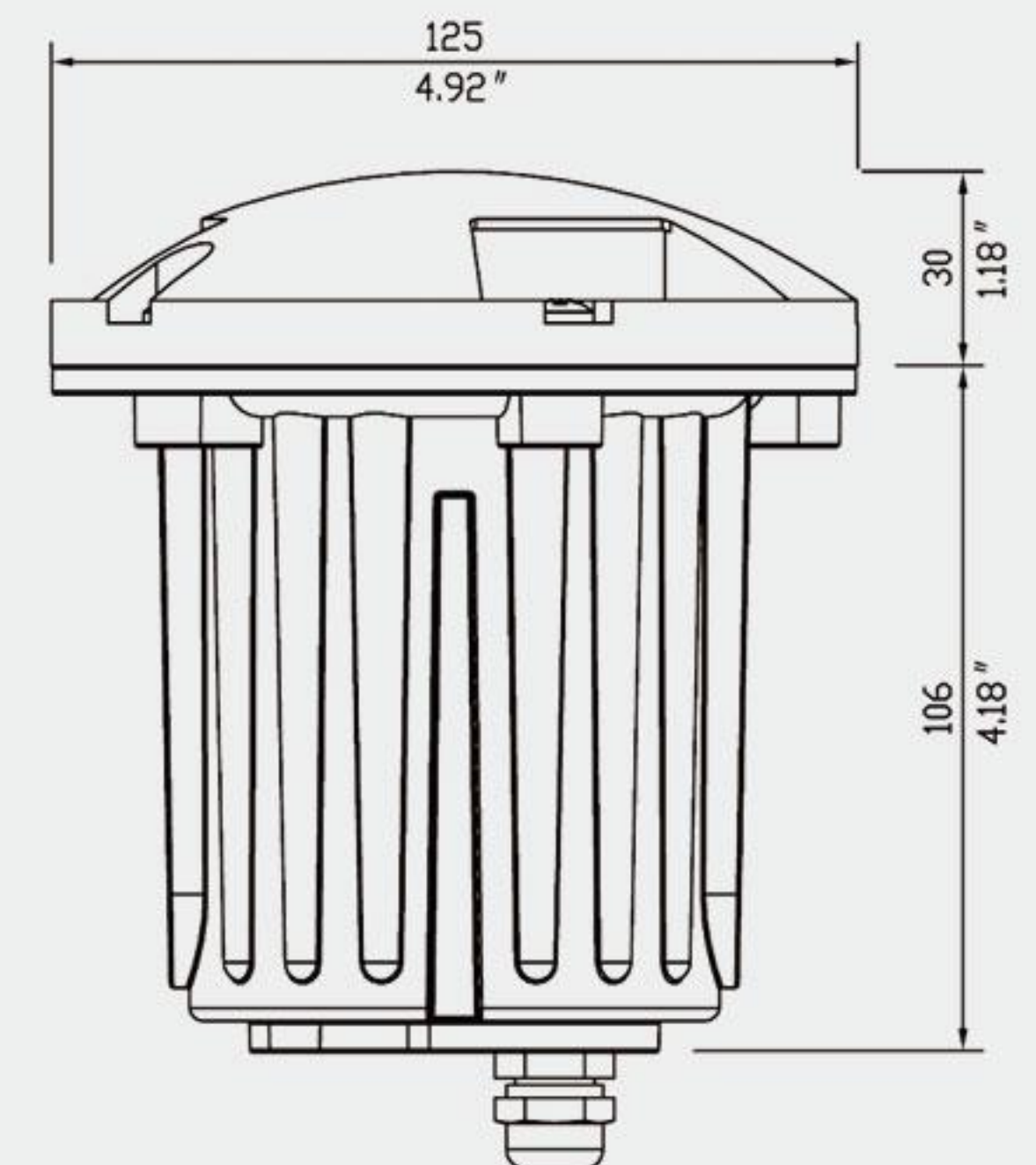

## Body

Corrosion resistant non-metallic canister  
Fully potted wire cavity provides water-tight seal  
Adjustable lamp gimble for optimal results

## Debris Guard

Solid cast brass faceplate with grate

## Lamp

For use with a halogen lamp up to 20W MR16 lamp.  
LT TECH LED lamps are available in 4W,5W and 6W  
MR16,in 2700K and 3000K.

## Materials

Die-cast brass,PVC

## Gasket

High-temperature silicone o-ring for a  
water-tight seal

## Lens

Shock resistant glass lens

## Warranty

Limited lifetime warranty





# IN-GROUND LIGHT FIXTURES

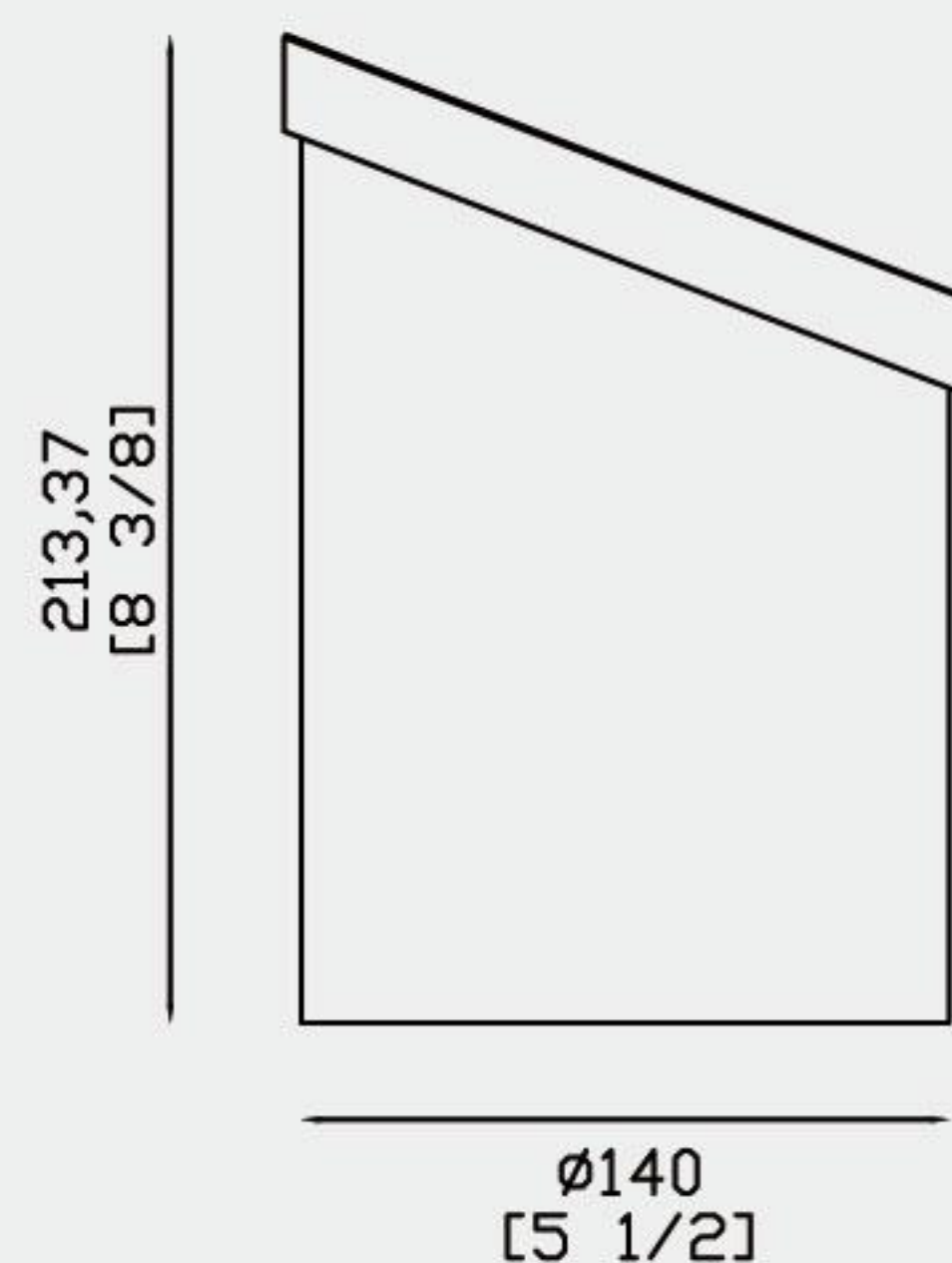

LT2205A

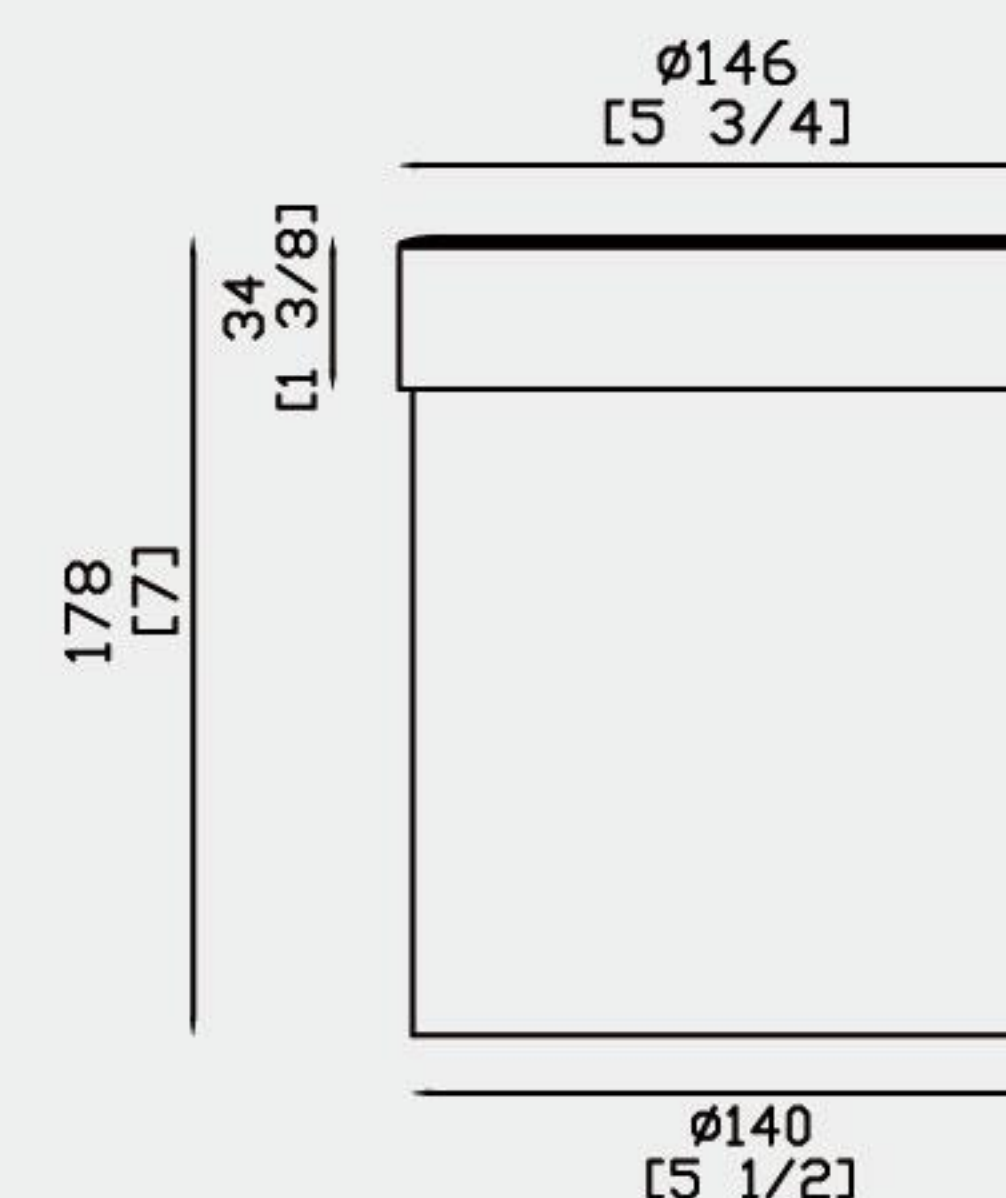

LT2205B

## Body

Corrosion resistant non-metallic canister  
Fully potted wire cavity provides water-tight seal  
Adjustable lamp gimble for optimal results

## Debris Guard

Solid cast brass faceplate with grate

## Lamp

For use with a halogen lamp up to 20W PAR36 lamp.  
LT TECH LED lamps are available in 6W,10W and 13W  
PAR36,in 2700K and 3000K.

## Materials

Die-cast brass,PVC

## Gasket

High-temperature silicone o-ring for a  
water-tight seal

## Lens

Shock resistant glass lens

## Warranty

Limited lifetime warranty





**LT2206A**

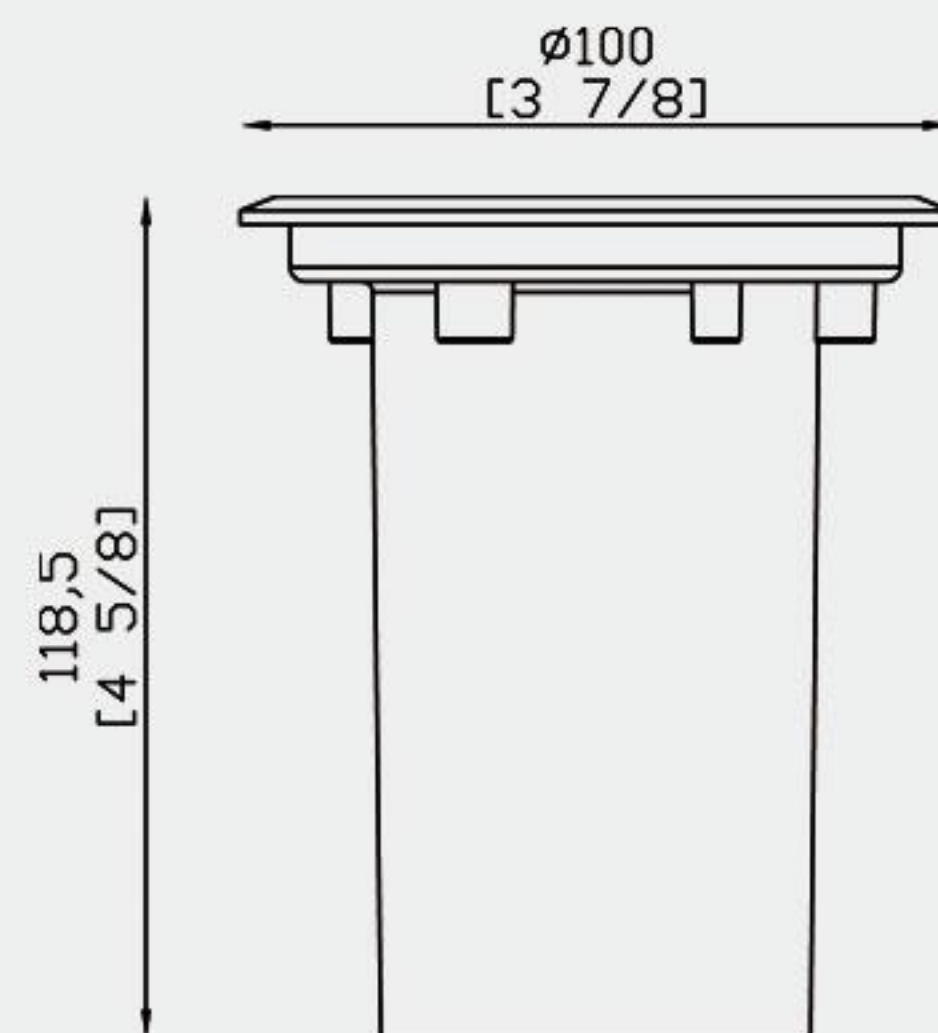

**LT2206B**

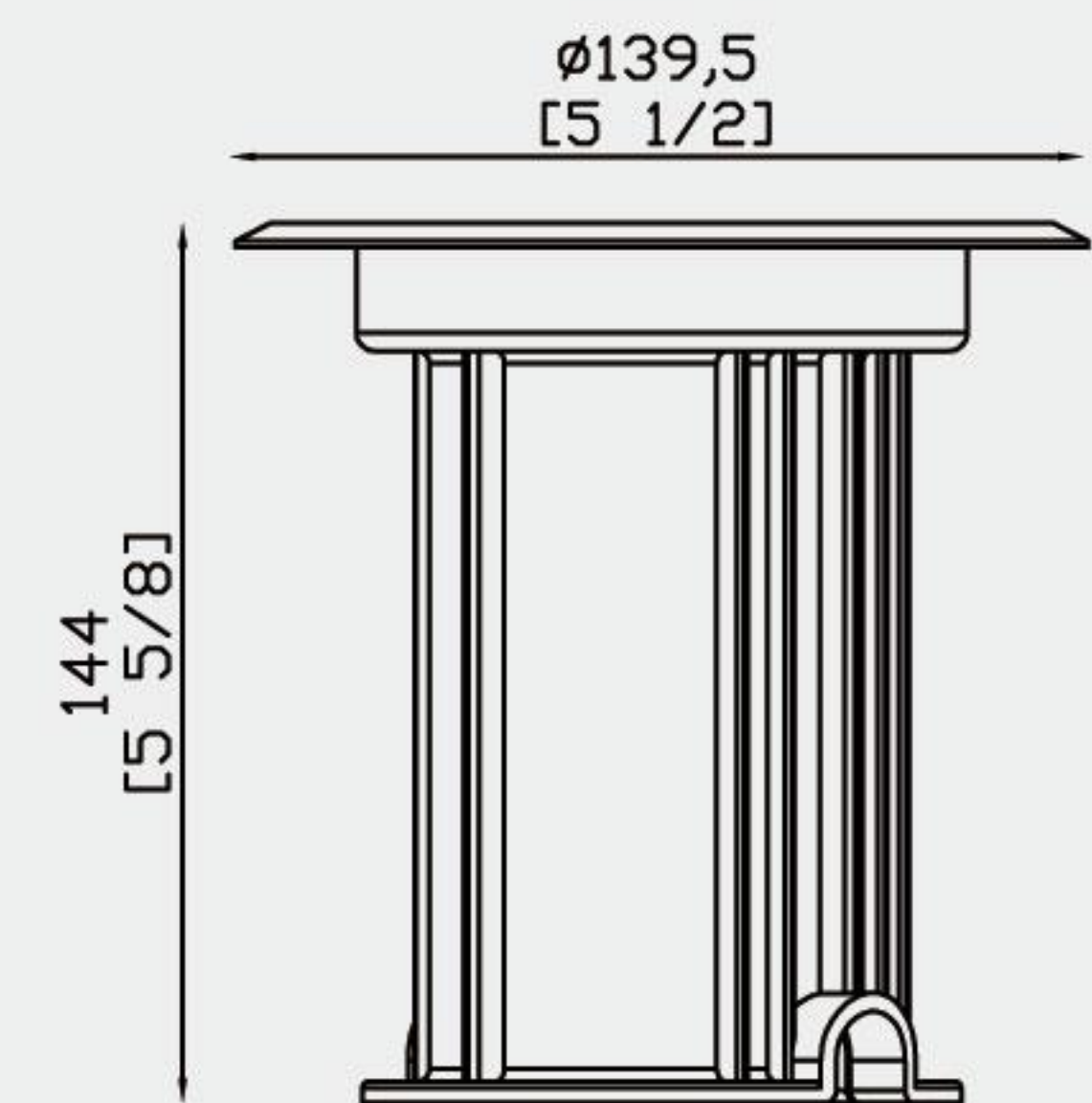

## Body

Corrosion resistant non-metallic canister  
Fully potted wire cavity provides water-tight seal  
Adjustable lamp gimble for optimal results

## Debris Guard

Solid cast brass faceplate with grate

## Lamp

For use with a halogen lamp up to 20W MR16 lamp.  
LT TECH LED lamps are available in 4W,5W and 6W  
MR16,in 2700K and 3000K.

## Materials

Die-cast brass,PVC

## Gasket

High-temperature silicone o-ring for a  
water-tight seal

## Lens

Shock resistant glass lens

## Warranty

Limited lifetime warranty